

FIRST FLOOR MEETING FACILITIES  
 THE IDAHO ROOM

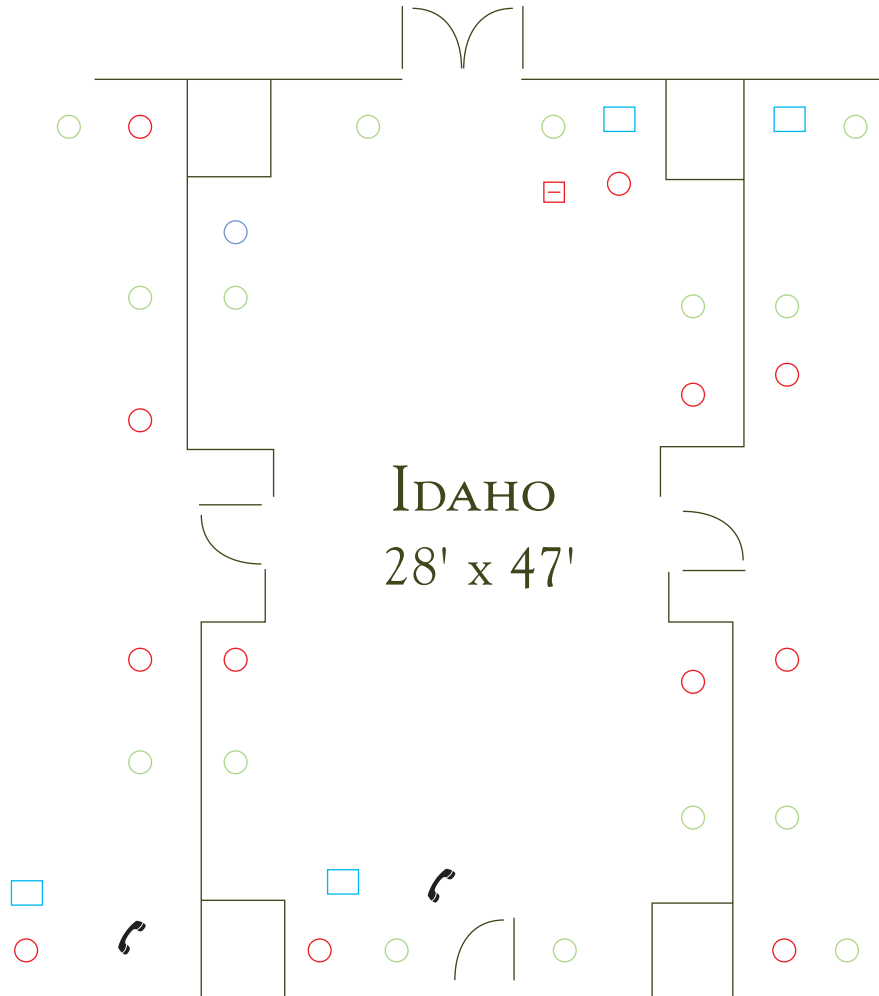

**LEGEND**

- |                              |                                    |
|------------------------------|------------------------------------|
| ○ ELECTRICAL OUTLET          | □ TV ANTENNA                       |
| ○ 208 VOLT 1 PHASE           | ○ MICROPHONE                       |
| ○ 30 AMP PLUG                | ☎ PHONE (CATEGORY 5 LINE IN ROOMS) |
| ○ 60 AMP PLUG (HUBBEL 26419) | □ LIGHT SWITCH                     |